

FOR LEASE

STRATHCONA TOWN CENTRE

7911-7915 104 STREET, EDMONTON, A.B.

PRIME LEASING OPPORTUNITIES ▷ 1,128 - 5,353 SF



Casey McClelland
Senior Managing Director
Casey.McClelland@MarcusMillichap.com

Mike Hoffert
Director
Mike.Hoffert@MarcusMillichap.com

Kevin Glass
Director
Kevin.Glass@MarcusMillichap.com

Marcus & Millichap

OVERVIEW + STATS / STRATHCONA TOWN CENTRE

7911-7915 104 STREET, EDMONTON, A.B.

ABOUT STRATHCONA TOWN CENTRE

Located in a high-exposure corridor, the Strathcona Town Centre benefits from strong visibility along both 104 Street and Gateway Boulevard, with convenient access from Calgary Trail as well. The site offers ample on-site parking, an uncommon advantage in Old Strathcona, and is just two blocks south of Whyte Avenue, placing it within one of Edmonton's most vibrant and pedestrian-friendly districts. Strathcona Town Centre is shadow anchored by Save-On-Foods, which draws significant daily traffic and reinforces the area as a key neighbourhood shopping destination.

HIGHLIGHTS

- New adjacent high-rise development, with three additional towers planned
- Prominent signage opportunity capturing both north and southbound traffic, access also available to non-tenants
- Prime central location near Whyte Avenue
- Ample parking on site
- Join strong mix of co-tenants including Community Natural Foods, Pet Valu, Orange Theory Fitness, Rice Bowl Deluxe, Crave Cupcakes and many more
- Convenient access off of Calgary Trail and Gateway Boulevard
- Close proximity to numerous residential developments including The Hat Apartments, a 500 unit luxury project



SALIENT DETAILS

Municipal Address: 7911 & 7915 104 Street, Edmonton, Alberta

Legal Description: Lot 9, Block 43, Plan 0420636 Lot 1B, Block , Plan 9622129

Vacancy:

- **Main Floor:** Unit 10335: 3,104 SF plus 556 SF **Basement**
- Unit 10343: 3,016 SF
- Unit 7909: 5,353 SF (Former Restaurant)
- Unit 7919: 1,128 SF
- **Second Floor:** 300-3,000 SF

Zoning: Mixed Use (MU h16 f3.5 cf)

Lease Rates: Market

Additional Rent:

- **Main Floor:** \$11.70 PSF (2026 est.)
- **2nd Floor:** \$14.30 PSF (2026 est.)

Possession: Immediate

VACANCIES / STRATHCONA TOWN CENTRE

7911-7915 104 STREET, EDMONTON, A.B.

3,660 SF
10339 80 AVE NW



1,128 SF
7919 104 STREET



3,016 SF
10343 80 AVE NW



5,353 SF
7903 104 STREET



SITE PLAN / STRATHCONA TOWN CENTRE

7911-7915 104 STREET, EDMONTON, A.B.

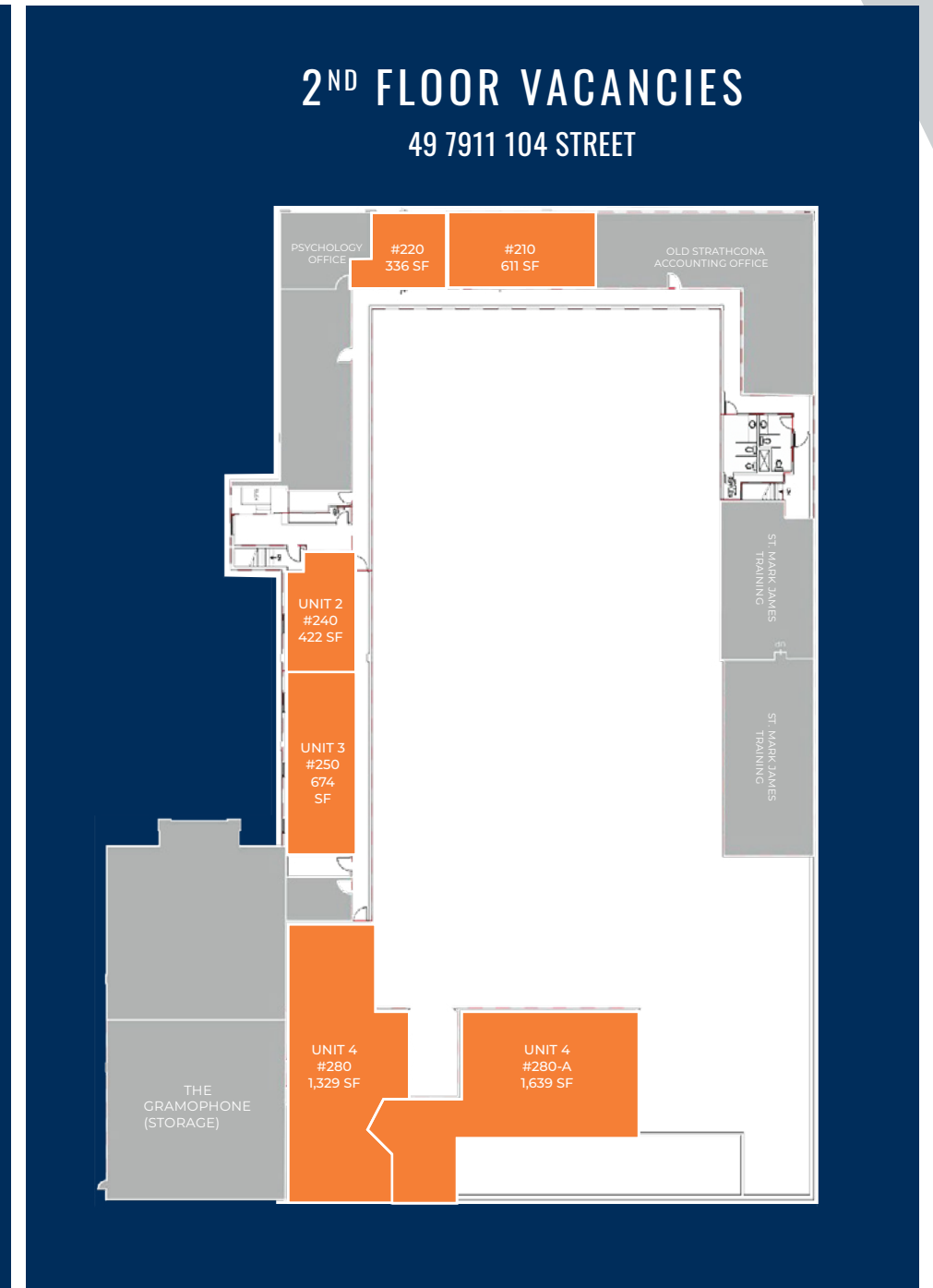
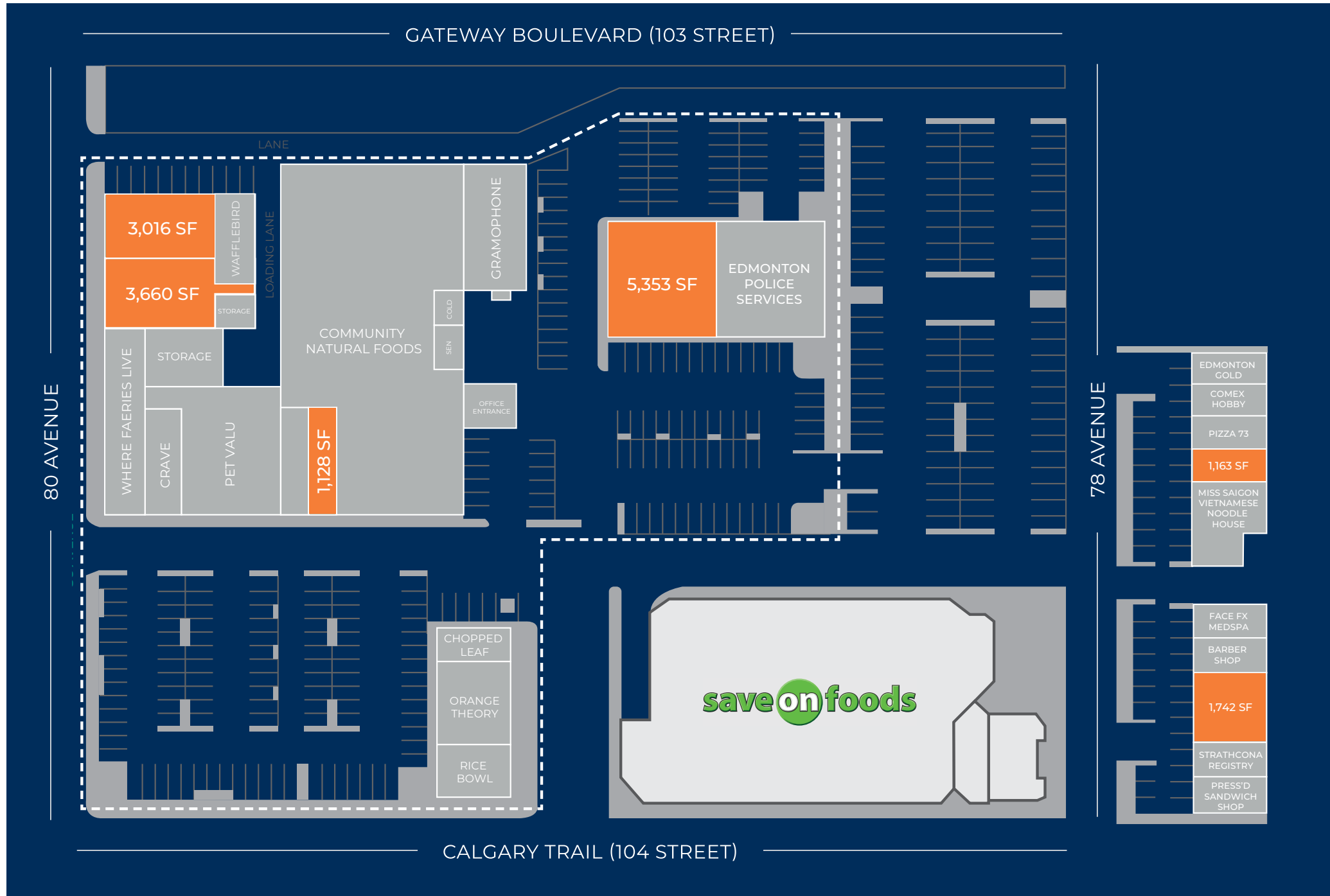

AREA + DEMOGRAPHICS / STRATHCONA TOWN CENTRE

7911-7915 104 STREET, EDMONTON, A.B.



15,048
VEHICLES PER DAY
(TWO-WAY) ALONG 104 STREET

15.1%
POPULATION CHANGE
(2025 - 2030 EST.)

36.1
MEDIAN
AGE

83,757
POPULATION WITHIN 3KM

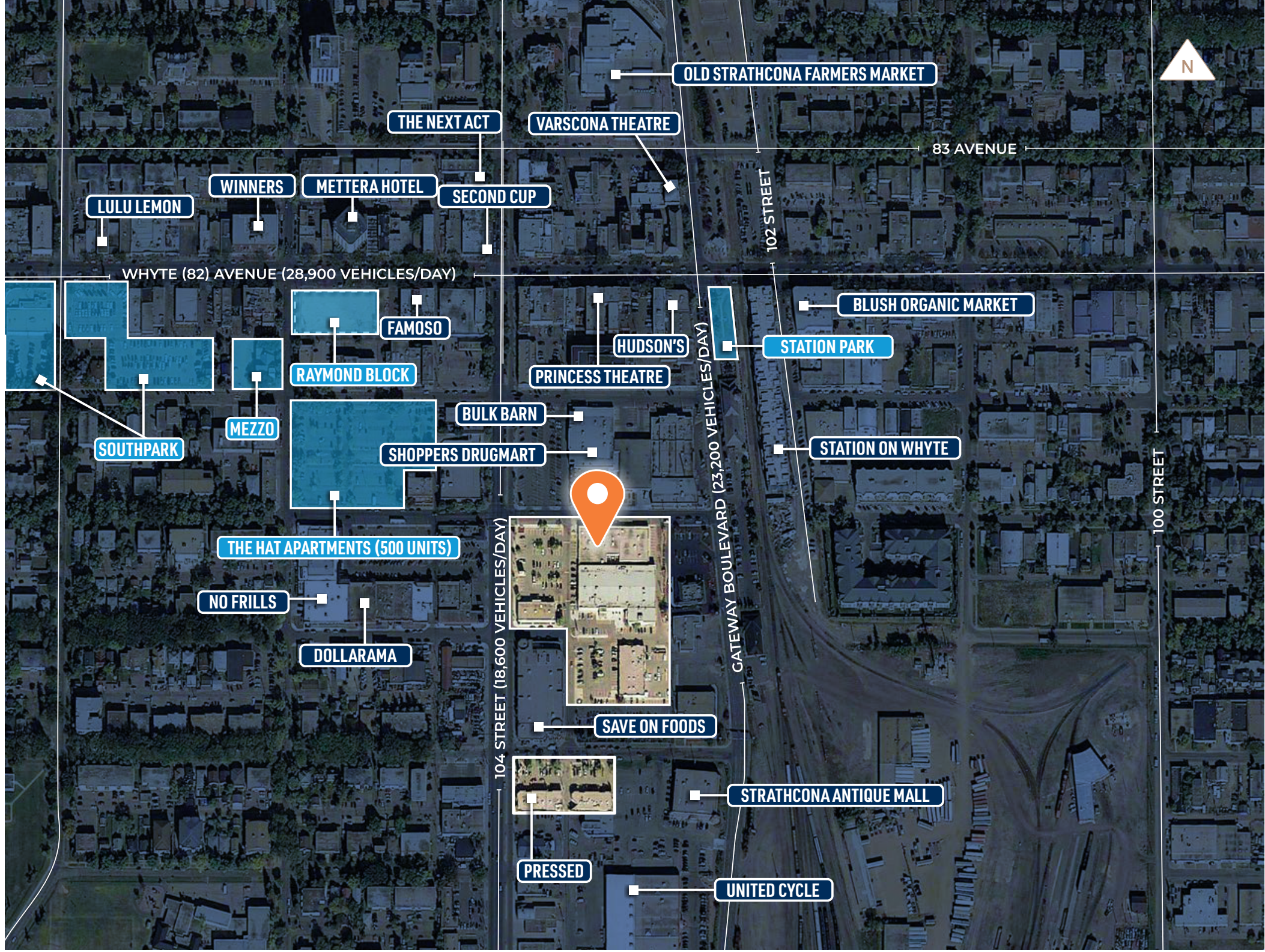
\$102,066
AVERAGE HOUSEHOLD INCOME
(2025 EST)





Marcus & Millichap

Marcus & Millichap 10175 - 101 Street
1820 Enbridge Centre Edmonton, AB T5J 0H3 +1 (587) 756 1600

Casey McClelland / Senior Managing Director
Casey.McClelland@ MarcusMillichap.com
+1 (587) 756 1560

Mike Hoffert / Director
Mike.Hoffert@MarcusMillichap.com
+1 (587) 756 1550

Kevin Glass / Director
Kevin.Glass@MarcusMillichap.com
+1 (587) 756 1570

The information contained in the following Marketing Brochure is proprietary and strictly confidential. It is intended to be reviewed only by the party receiving it from Marcus & Millichap and should not be made available to any other person or entity without the written consent of Marcus & Millichap. This Marketing Brochure has been prepared to provide summary, unverified information to prospective purchasers, and to establish only a preliminary level of interest in the subject property. The information contained herein is not a substitute for a thorough due diligence investigation. Marcus & Millichap has not made any investigation, and makes no warranty or representation, with respect to the income or expenses for the subject property, the future projected financial performance of the property, the size and square footage of the property and improvements, the presence or absence of contaminating substances, PCB's or asbestos, the compliance with State and Federal regulations, the physical condition of the improvements thereon, or the financial condition or business prospects of any tenant, or any tenant's plans or intentions to continue its occupancy of the subject property. The information contained in this Marketing Brochure has been obtained from sources we believe to be reliable; however, Marcus & Millichap has not verified, and will not verify, any of the information contained herein, nor has Marcus & Millichap conducted

any investigation regarding these matters and makes no warranty or representation whatsoever regarding the accuracy or completeness of the information provided. All potential buyers must take appropriate measures to verify all of the information set forth herein. Marcus & Millichap is not affiliated with, sponsored by, or endorsed by any commercial tenant or lessee identified in this marketing package. The presence of any corporation's logo or name is not intended to indicate or imply affiliation with, or sponsorship or endorsement by, said corporation of Marcus & Millichap, its affiliates or subsidiaries, or any agent, product, service, or commercial listing of Marcus & Millichap, and is solely included for the purpose of providing tenant lessee information about this listing to prospective customers. This information has been secured from sources we believe to be reliable, but we make no representations or warranties, express or implied, as to the accuracy of the information. References to square footage or age are approximate. Buyer must verify the information and bears all risk for any inaccuracies. Marcus & Millichap is a trademark of Marcus & Millichap Real Estate Investment Services, Inc. Used under license by Marcus & Millichap Real Estate Investment Services Canada Inc. © 2026 Marcus & Millichap. All rights reserved.