



Suburban Office For Lease

Well-maintained four (4) storey office building ideally situated in a suburban setting in south Regina. Parliament Place is comprised of a good mix of professional service tenants. Discover what suburban office life can do for your business.

The building is professionally managed, and has seen recent updates.



Get more information:

Jeremy Schick, Associate Broker
D 306.559.9004
jeremy.schick@avisonyoung.com

Hali Lawrence, Sales & Leasing
D 306.559.9006
hali.lawrence@avisonyoung.com

Contact: our local office:

2550 12th Avenue
Suite 300
Regina, SK S4P 3X1
306.559.9000

2631 28th Avenue

PROPERTY DETAILS

AVAILABLE AREA

Suite 401 1,208 sf approx.

AVAILABILITY

Suite 401 August 1st, 2026

LEASE RATE (NET)

Market

ADDITIONAL RENT (2026)

\$17.85 psf

TERM

5 Years - Negotiable

ZONING

MH - Mixed High Rise

FEATURE

- » Suburban office setting
- » Abundance of natural light
 - Large windows in available spaces
- » Ample Parking
 - Surface stalls in adjacent lot
 - \$70.00 per month per stall
- » Building is wheelchair accessible
- » Close to transit and bike paths
- » Building is professionally managed

LOCATION

Conveniently located just off Albert Street, Parliament Place is close to numerous amenities and services, with quick access to public transit and Ring Road. Perfect for tenants looking for a professional setting outside of the downtown core.



Trade Area Demographics

Within 3 KM



16,538

Average Households



40,883

Area Population



Walking Distance

to Southland Shopping Mall



Walking Distance

to nearby full service restaurants



29,200 VPD Along ALBERT STREET

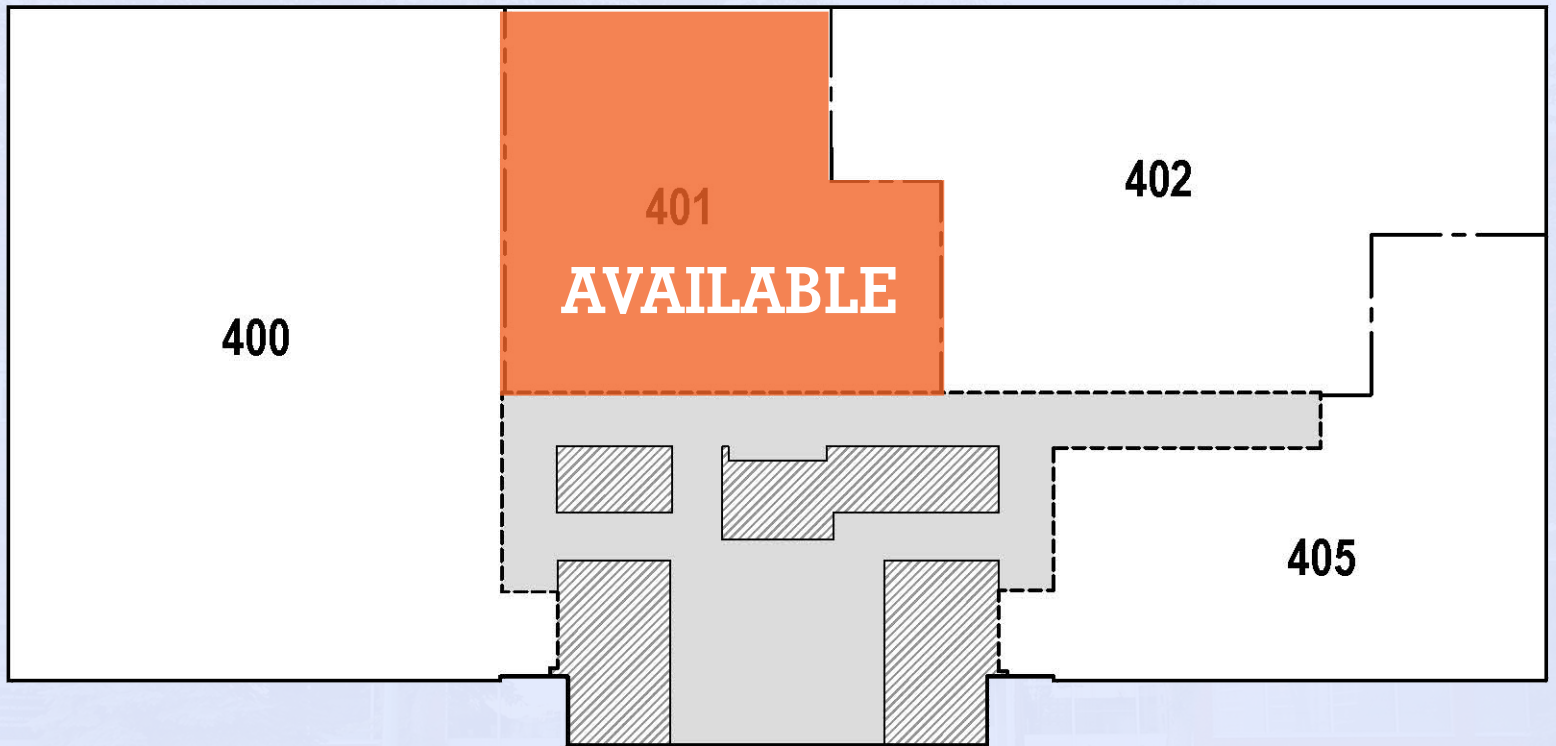

avisonyoung.com

Jeremy Schick, Associate Broker
D 306.559.9004
jeremy.schick@avisonyoung.com

Hali Lawrence, Associate Broker
D 306.559.9006
hali.lawrence@avisonyoung.com