

FOR LEASE

Modern retail/ medical units

18 Inglewood Drive,
St. Albert, AB



Arlyn Stoik
Principal
+1 780 429 7552
arlyn.stoik@avisonyoung.com

Alison Hansen-Carlson
Senior Associate, Brokerage Services
+1 780 702 0692
alison.hansen-carlson@avisonyoung.com

**AVISON
YOUNG**

For Lease

18 Inglewood Drive, St. Albert, AB

Property Details

Modern retail/professional units ranging from 1,200 sf bays to 8,780 sf. The unique design and finishings of Inglewood Drive will provide tenants a premier retail and professional option in St. Albert.

Conveniently located just off of busy St. Albert Trail, the arterial road through St. Albert, with traffic counts of over 23,000 vehicles per day (2019).

Available Summer 2025



Population
54,351



Median age
42.1



Vehicles per day
23,639 (St. Albert Trail)



Average household income
\$168,233

*Demographics: Within 3km, Sitewise
Traffic: 2019 Average Daily Volume, City of St. Albert*

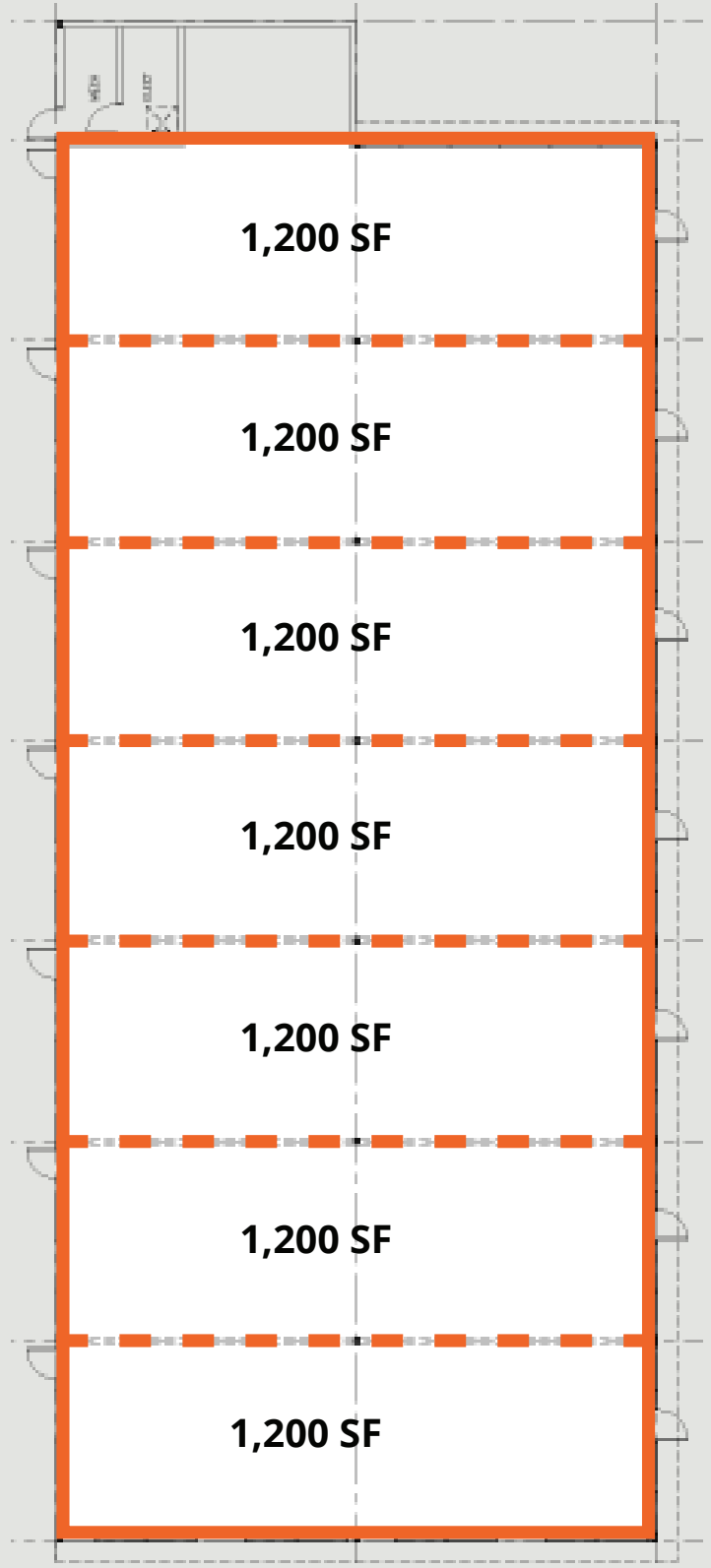
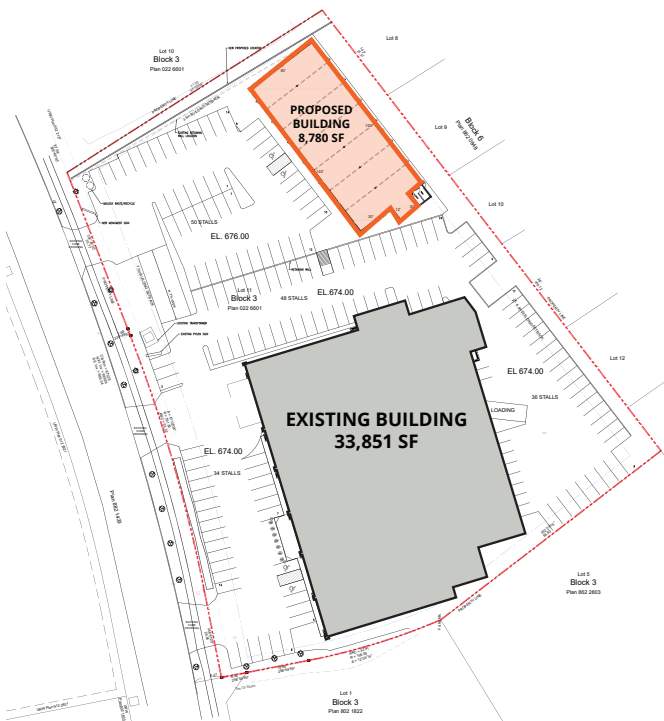

For Lease

18 Inglewood Drive, St. Albert, AB



For Lease

18 Inglewood Drive, St. Albert, AB

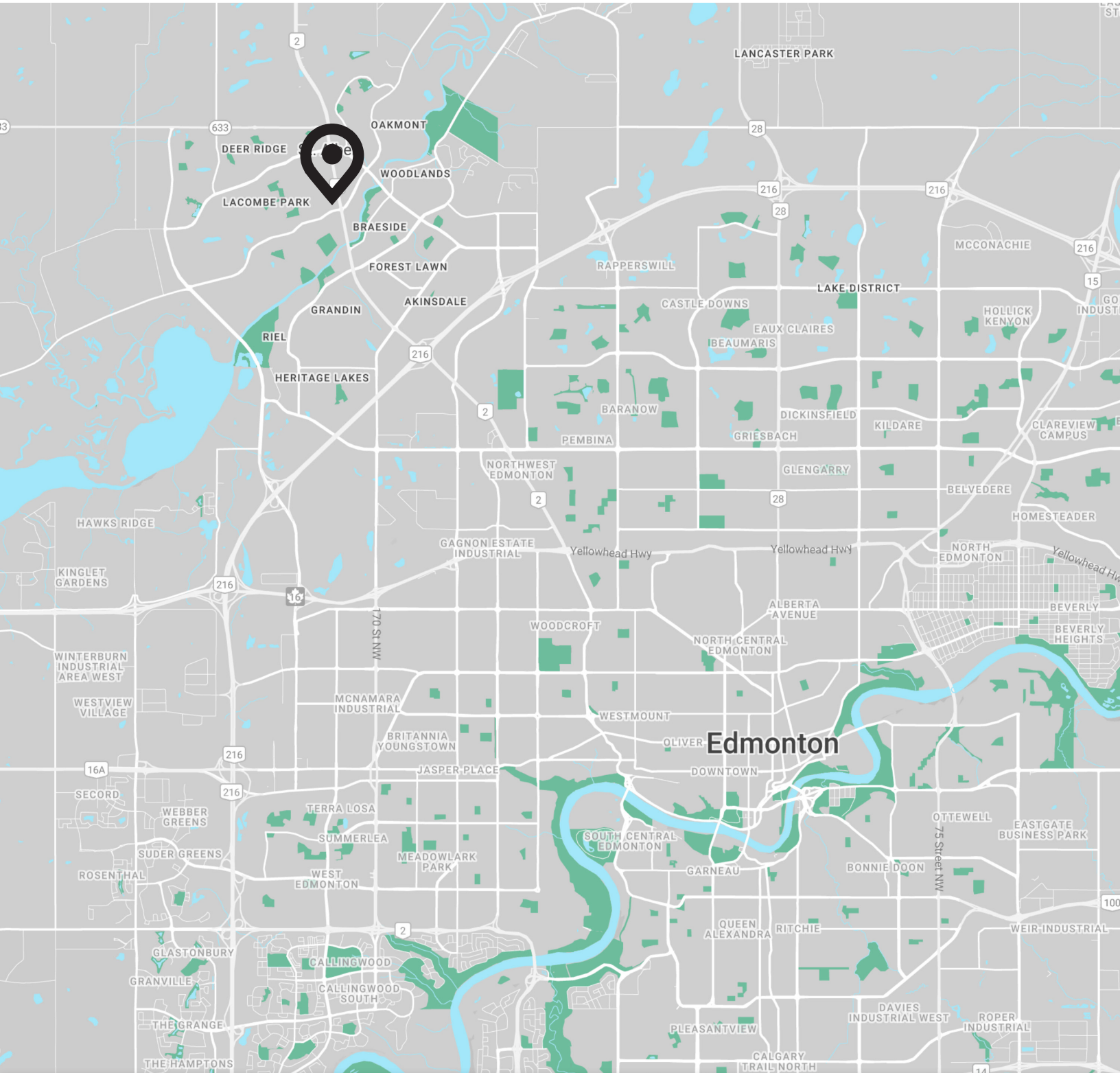

Get more
information

Arlyn Stoik
Principal
+1 780 429 7552
arlyn.stoik@avisonyoung.com

Alison Hansen-Carlson
Senior Associate, Brokerage Services
+1 780 702 0692
alison.hansen-carlson@avisonyoung.com

**AVISON
YOUNG**